

Stage

Stage dimensions

Width / Depth: 6 × 6m

Stage height: 1.2m

Clear height: 4.2m

Height under light equipment SL & SR 3.3m

Height under light equipment stage center 3.6m

Wings

Stage Left: 2.5m x 2m

Stage Right: 2.5m x 0.80m

PLEASE RESPECT EMERGENCY PASSWAYS / EXITS!

Risers

18x Büttec Riser 2 × 1m
 06x Büttec Riser 1 × 1m
 02x Büttec Riser 2 × 0.50m

Legs (fix)

32x 20cm
 16x 30cm
 52x 40cm
 28x 60cm
 20x 100cm
 20x 120cm
 12x 50 – 85cm, variable

Legs (wheels)

09x 20cm, single
 05x 20cm, double
 09x 40cm, single
 05x 40cm, double
 05x 60cm, single
 02x 60cm, double

FOH

Position

No fixed FOH-Position

It can be discussed with local P/M on showday.

If the show is sold out, please don't waste any space.

Cabling

Cable ways for guest cables to FOH are prepared.

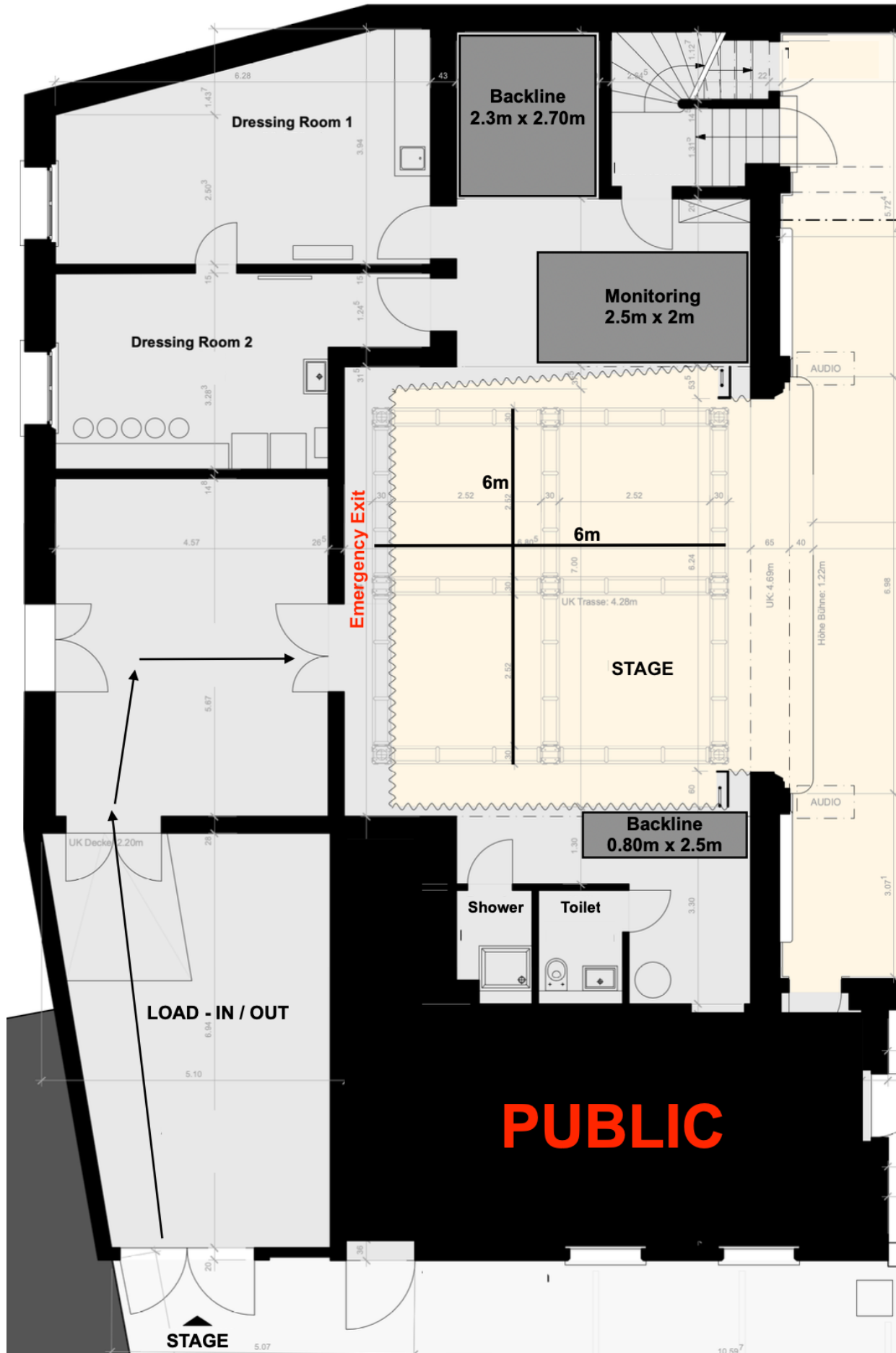



BIERHÜBELI

Power

Cables

01x CEE16/5, 5m
03x CEE16/5, 10m
01x CEE16/5, 20m
01x CEE32/5, 30m (for night liner)
01x CEE32/5, 20m

Adapters

01x CEE16/5 → 1x CEE16/3 (phase 1)
01x CEE16/5 → 3x CEE16/3 (3 phases; stage power)
01x CEE16/3 → 6x T13; 2x Euro/Schuko (stage power)
01x CEE32/5 → 1x CEE63/5
01x CEE32/5 → 1x CEE63/3 (blue; 32A only)
01x CEE32/5 → 3x CEE32/3 (blue)

Power distribution

01x CEE32 IN/OUT
→ 2 × CEE16/5 OUT

01x CEE32/5 IN
→ 2 × CEE16/5 OUT
→ 3 × CEE16/3 (blue) OUT

01x CEE 63/5 IN
→ 4 × CEE 32/5 OUT

Distribution stage left (audio)

- 1x CEE32/5
- 3x CEE16/5
- 3x CEE16/3
- 1x PA rack (circuit breaker: D40A, no RCD)
- 1x CEE16/3 for audio (stage right)

Main fuse for audio & light (together): 100A

Dimmer

- 1x CEE32/5
- 1x CEE16/5

Main fuse for audio & light (together): 100A

Distribution stage left (light)

- 1x CEE63/5 (circuit breaker D40A, no RCD)
- 1x CEE32/5 (on the same circuit breaker but with additional RCD)
- 5x T13

Main fuse for general use: 63A

Distribution garage (NL / Trucks)

- 1x CEE63/5 (direct throughout from input, no RCD)
- 2x CEE32/5 on one C32A circuit breaker
- 2x CEE16/5 and T25 together on C16A circuit breaker
- 3x T23 on C16A circuit breaker

Main fuse for general use: 63A

Distribution stage left (audio)

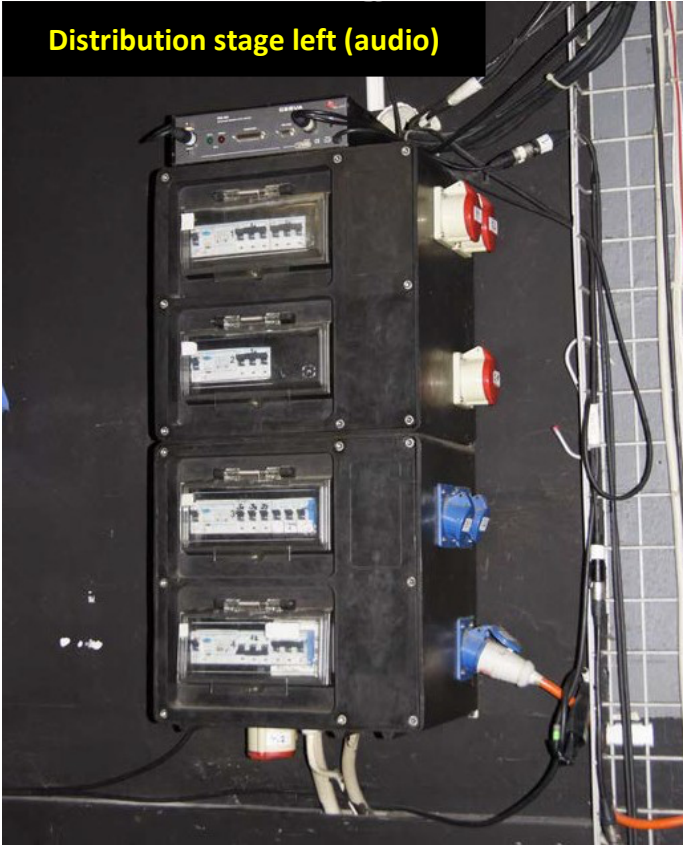

Distribution stage left (light)



Distribution garage (NL / Trucks)



Audio power stage right

